

1080 Series Ball Check Valve, Flange End, 1 1/2"-14"

SPECIFICATION

- FULLY RUBBER COATED ALUMINUM BELT
- FUNCTIONS EVEN AT A LOW PRESSURE
- FREE LOW PASSAGE, BLOCKAGE-FREE
- LOW FRICITIONAL LOSSES
- FOR SEWAGE PRONE TO BLOCKAGE

WORKING PRESSURE

- 16 BAR

WORKING TEMPERATURE

- -10°C TO 120°C FOR EPDM SEAT
- -10°C TO 82°C FOR NBR SEAT

CORROSION PROTECTION

- INTERNALLY AND EXTERNALLY FUSION BONDED EPOXY POWDER COATED (FBE)

DESIGN AND MATERIALS ARE SUBJECT TO CHANGE WITH OUT NOTICE

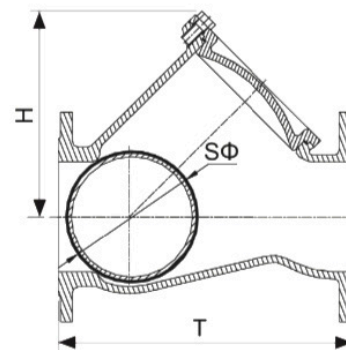

MATERIAL SPECIFICATION

PART NAME	MATERIAL	EN SPEC.	ASTM SPEC.
BODY	DUCTILE IRON	EN-JS1050	A536 65-45-12
COVER	DUCTILE IRON	EN-JS1050	A536 65-45-12
BALL	ALUMINUM NBR/EPDM COATED	EN1706 AC-42100	ANSI H35.1(M) 356.0
GASKET	NBR/EPDM	COMMERCIAL	COMMERCIAL

DIMENSIONS

Unit: inches

SIZE	1 1/2"	2"	2 1/2"	3"	4"	5"	6"	8"	10"	12"	14"
T	7.09	7.87	9.45	10.24	11.81	13.78	15.75	19.69	23.62	27.56	31.50
H	3.94	4.92	5.51	7.09	8.15	8.86	11.02	13.98	16.54	18.90	22.83
SΦ	1.97	2.48	3.15	3.78	4.92	5.91	7.09	9.84	12.60	14.57	16.30
WEIGHT (KG)	8	9	11	13	20	32	42	74	138	200	310