

## 825 Series Swing Check Valve, Flanged Ends MATERIALS OF CONSTRUCTION

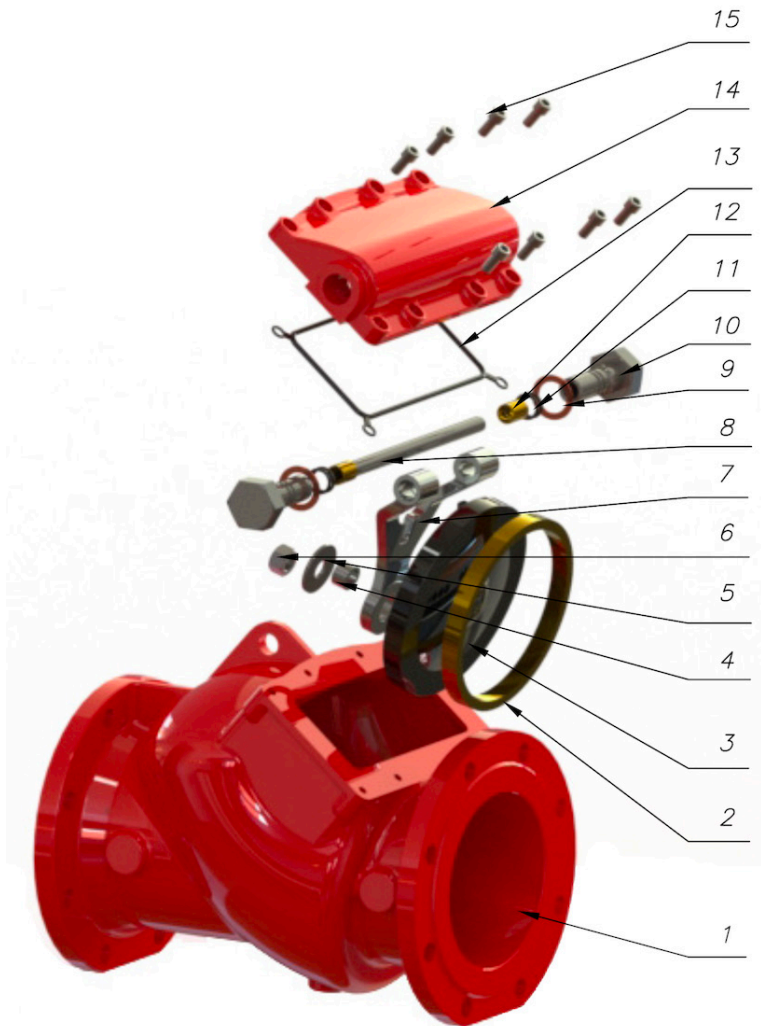

### COMPONENTS

| NO. | PART      | MATERIAL   | ASTM SPECIFICATION                    |
|-----|-----------|--|---------------------------------------|
| 1   | BODY      | DUCTILE IRON                                       | A536 GRADE 65-45-12                   |
| 2   | BODY SEAT | BRONZE   | B62 C83600                            |
| 3   | DISC      | DUCTILE IRON WITH EPDM FULLY ENCAPSULATED          |                                       |
| 4   | BUSHING   | STAINLESS STEEL                                    |                                       |
| 5   | WASHER    | STAINLESS STEEL                                    |                                       |
| 6   | NUT       | STAINLESS STEEL                                    |                                       |
| 7   | HINGE     | 2"-6"<br>8"-12"<br>STAINLESS STEEL<br>DUCTILE IRON | A351 GRADE CF8<br>A536 GRADE 65-45-12 |
| 8   | HINGE PIN | STAINLESS STEEL                                    | A276 TYPE 304                         |
| 9   | WASHER    | COPPER   |                                       |
| 10  | PLUG      | STAINLESS STEEL                                    | A276 TYPE 304                         |
| 11  | O-RING    | RUBBER   | NBR/EPDM                              |
| 12  | BUSHING   | BRONZE   | B148 C95200                           |
| 13  | GASKET    | RUBBER   | D2000 EPDM                            |
| 14  | BONNET    | DUCTILE IRON                                       | A536 GRADE 65-45-12                   |
| 15  | BOLT      | CARBON STEEL                                       |                                       |