

## 854 Series Basket Strainers

### SPECIFICATIONS

MEETS OR EXCEEDS THE REQUIREMENTS OF UL 321 STANDARD  
 RECESSED SEAT IN BODY ASSURES ACCURATE SCREEN ALIGNMENT  
 ROUND HOLES WITH 60° STAGGERED  
 EXCELLENT FLOW CHARACTERISTICS AND LOW PRESSURE LOSSES AT HIGH FLOW RATES  
 SIZES 3" AND ABOVE COME WITH LIFTING EYEBOLT  
 SIZES 3"-6" PLUG T BOTTOM OF BODY  
 SIZES 8"-12" PLUG AT SIDE OF BODY  
 FRICTION LOSS NOT MORE THAN 10 PSI DURING TESTING  
 CONNECTION ENDS: ASME B16.1 CLASS 125 OR EN 1092-2 PN 10/16  
 WORKING PRESSURE 200 PSI  
 WORKING TEMPERATURE -10°C TO 120°C  
 UL 321 / ULC LISTED  
 FUSION BONDED EPOXY COATED INTERIOR AND EXTERIOR TO AWWA C550 STANDARD  
 STANDARD SCREENS: 1/8" HOLE DIAMETER AND 37.15% FREE FLOW AREA OPENING

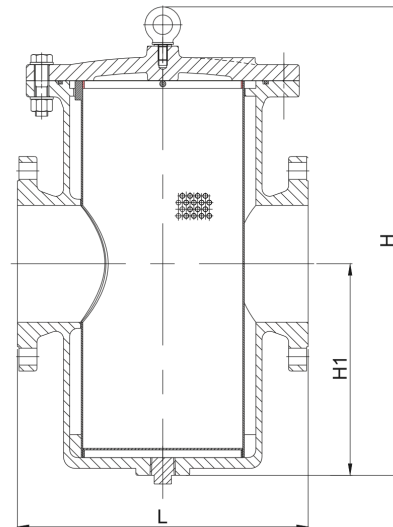

### COMPONENTS

NO.	PART NAME	MATERIAL
1	BODY	DUCTILE IRON A536 GR.65-45-12
2	COVER	DUCTILE IRON A536 GR.65-45-12
3	SCREEN	STAINLESS STEEL A276 TYPE 304
4	BODY/COVER GASKET	RUBBER EPDM D2000
5	BODY/COVER BOLTS	CARBON STEEL A307 GRADE B
6	PLUG	MALLEABLE IRON A47 GRADE 22010

### DIMENSIONS

	(INCHES)						
SIZE	3	4	5	6	8	10	12
L	9.85	11.50	13.40	14.88	18.70	22.00	26.75
H	12.50	19.00	20.50	25.00	27.50	30.50	38.00
H1	6.00	8.00	9.00	11.00	12.00	14.00	18.00
PLUG SIZE	3/4"	1"	1"	1"	1 1/2"	1 1/2"	2"